

Tried and trusted technology:
Complete series of two-platen clamping unit machines from
ENGEL duo 500 pico to ENGEL duo 5500

Maximum power in a small space. This is what ENGEL duo large-scale machines with two-platen clamping unit stand for. For many years. And very successfully. Since 1996, more than 2,000 machines are utilised worldwide. This means: A tried and trusted technology.

For example the sophisticated platen guiding system providing excellent platen parallelism and minimal mould wear. Or the hydro-mechanical clamping system which has substantial benefits compared with similar concepts: The far shorter oil column in the pressure pads allows reduced energy requirements and a shorter dry cycle on the one hand, and improved locking pressure on the other hand.

Coming soon: ENGEL duo 600 and 700 pico

The new ENGEL duo pico machines bring this proven high-tech quality of large-scale machines to the 500 to 700 tonne clamping force class. With the ENGEL duo 500 pico. And the duo 600 and 700 pico which will be available soon.



ENGEL duo 500 pico
powerful inside. compact outside. **pico.**
The new small ENGEL duo.

powerful inside. compact outside. **pico.**
The new small ENGEL duo.

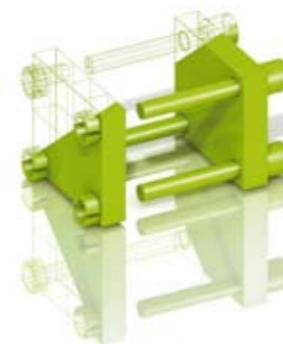

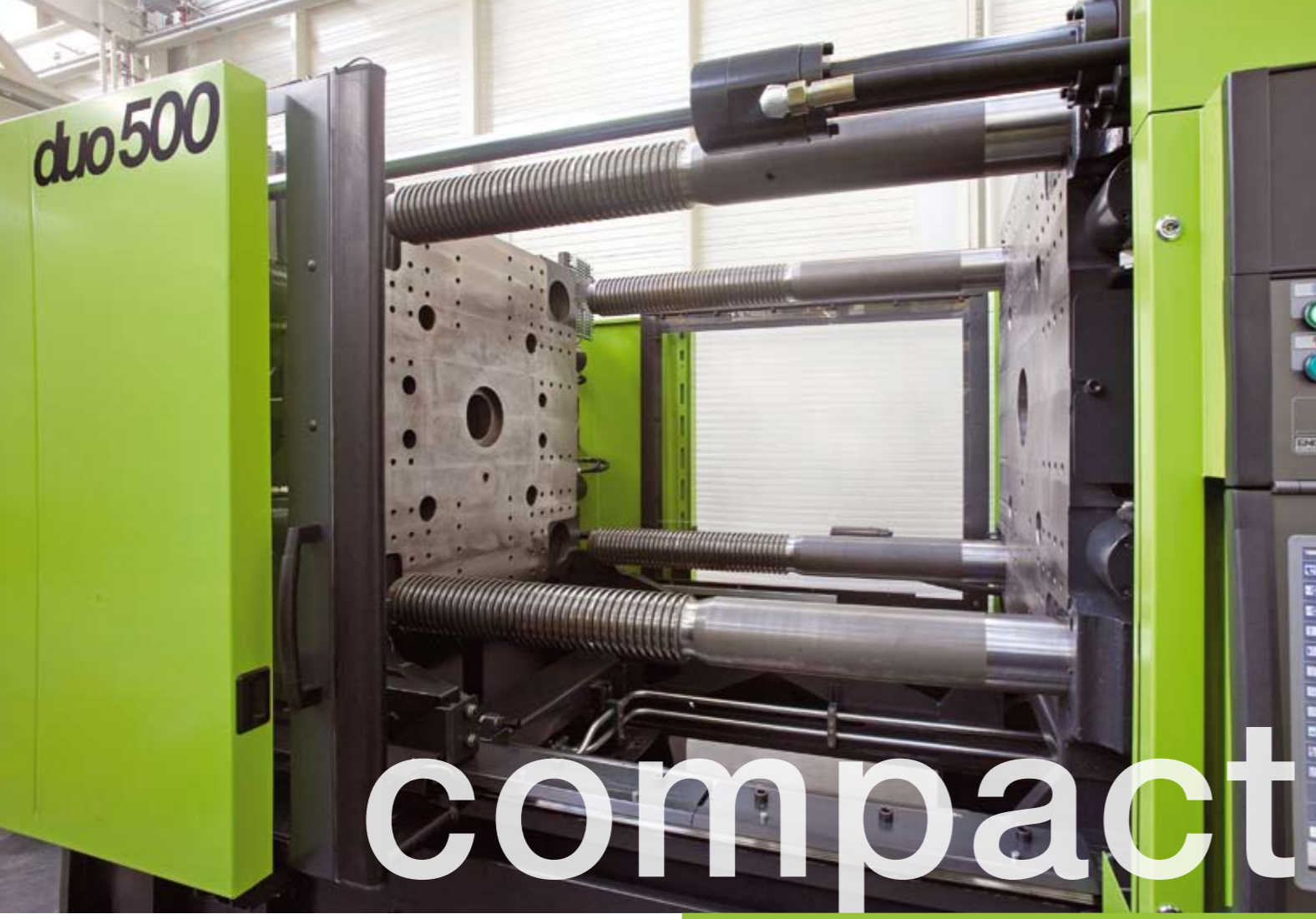

compact

ENGEL duo 500 pico. Small but powerful:

- > fastest two-platen machine, with a dry cycle time of only 2.6 seconds (according to Euromap 6)
- > minimum footprint thanks to compact two-platen clamping system
- > reliable and robust: highest level of operating safety, excellent part quality and minimum mould wear thanks to stable platen control, highly precise platen parallelism and high platen rigidity
- > energy efficient thanks to optimised drive power, reduced weight and frictionless movements due to zero contact between tie bars and platen
- > convenient operations and maintenance thanks to free access to the mould and ejector area and the new, ergonomic ENGEL CC 200 machine control
- > supplied with a discharge chute as a factory standard: Operators can simply and quickly transport parts discharged at the operator side, rear, or front of the machine by means of conveyor belts.
- > maximum variability with respect to mould installation height: Min. 250 mm to max. 1100 mm
- > can be extended modularly using numerous options, such as:
 - wide-platen option
 - combi M option for large-area, two component parts and for double-daylight moulds
 - prepared for the full range of technology modules applicable on ENGEL duo large-scale machines, such as ENGEL glazemelt, Dolphin, etc.

Compact Powerhouse

Reliable, robust and powerful. And very compact thanks to the two-platen clamping unit. The new ENGEL duo 500 pico now brings the proven advantages of large-scale machines to the 500-tonne clamping force class. Including highly precise platen parallelism. And: With a dry cycle time of only 2.6 seconds the machine is extremely fast. The ENGEL duo 500 pico is very cost effective not only in terms of purchase – where it wins people over with its extensive basic equipment – but also during operation. Thanks to a wide range of technology options the machine can modularly be upgraded. This means: Maximum flexibility – for a great variety of special injection moulding requirements



Compact power on 7,210 mm length. ENGEL duo 2050/500 pico. Thanks to optimised ergonomic design the mould area is perfectly accessible.



Shortest dry cycle time thanks to synchronised locking device and reduced moving platen weight. And: Perfect access to the ejector.